



HUNTERS[®]
HERE TO GET *you* THERE

45 Brindley Close, Norton Lees, Sheffield, S8 8PX

45 Brindley Close, Norton Lees, Sheffield, S8 8PX

£210,000

Nestled in the top corner of Brindley Close, Norton Lees is this delightful townhouse. Boasting a ground floor cloakroom/w.c. and modern fitted dining kitchen makes this property ideal for first time buyers and families alike. The living room has a solid wood floor and overlooks the rear garden.

As you rise to the first floor landing there are three bedrooms, with the current vendors using the second bedroom as a further living room and a modern shower room with walk in shower.

One of the highlights of this townhouse is its prime location at the top corner of the estate, offering privacy and tranquillity. Additionally, the level garden wraps around from the side to the rear providing the perfect spot for outdoor gatherings and as a "grow your own" area.

Don't miss the opportunity to make this charming townhouse your own - book a viewing today and step into your future home in Norton Lees.

GENERAL REMARKS

TENURE

This property is Freehold.

RATING ASSESSMENT

We are verbally advised by the Local Authority that the property is assessed for Council Tax purposes to Band A.

VACANT POSSESSION

Vacant possession will be given on completion and all fixtures and fittings mentioned in the above particulars are to be included in the sale.

MORTGAGE FACILITIES

We should be pleased to advise you in obtaining the best type of Mortgage to suit your individual requirements. YOUR HOME IS AT RISK IF YOU DO NOT KEEP UP REPAYMENTS ON A MORTGAGE OR OTHER LOANS SECURED ON IT.

Hunters Sheffield - Woodseats 764 Chesterfield Road, Woodseats, S8 0SE | 0114 258 0111
sheffieldwoodseats@hunters.com | www.hunters.com

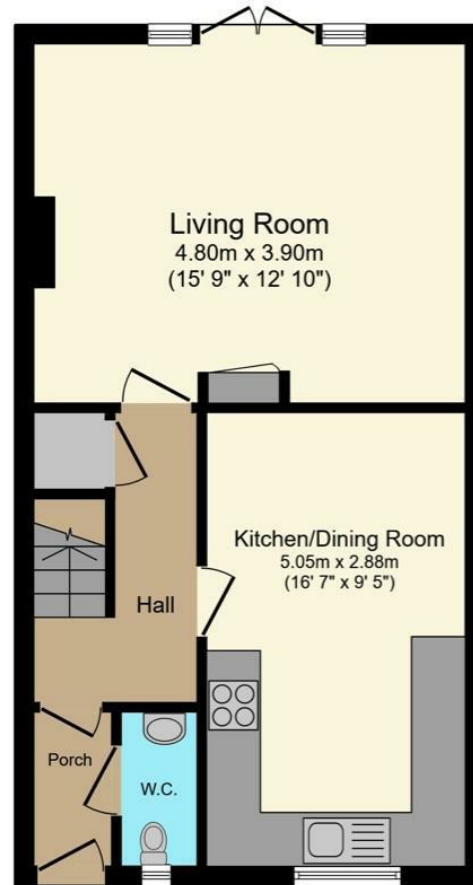

Ground Floor

Floor area 43.9 m² (473 sq.ft.) approx

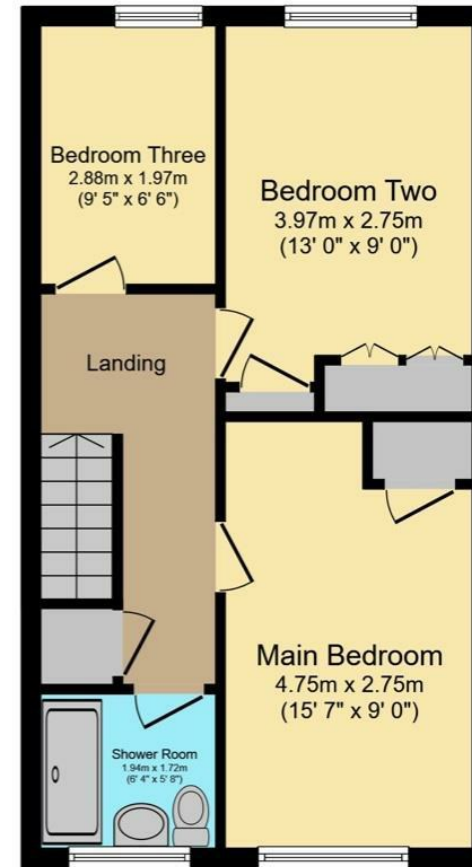

First Floor

Floor area 43.9 m² (473 sq.ft.) approx

Total floor area 87.8 m² (945 sq.ft.) approx

This floor plan is for illustrative purposes only. It is not drawn to scale. Any measurements, floor areas (including any total floor area), openings and orientation are approximate. No details are guaranteed, they cannot be relied upon for any purpose and they do not form part of any agreement. No liability is taken for any error, omission or misstatement. A party must rely upon its own inspection(s). Powered by www.focalagent.com

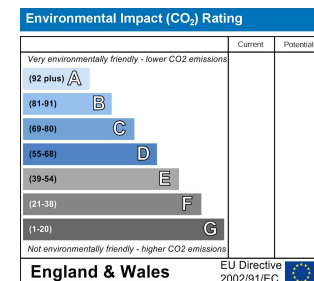
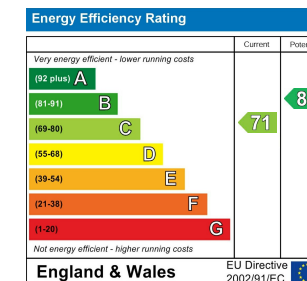

Energy Efficiency Rating

	Current	Potential
<i>Very energy efficient - lower running costs</i> <div> <div>(92 plus) A</div> <div>(81-91) B</div> <div>(69-80) C</div> <div>(55-68) D</div> <div>(39-54) E</div> <div>(21-38) F</div> <div>(1-20) G</div> </div> <i>Not energy efficient - higher running costs</i>	71	85
England & Wales	EU Directive 2002/91/EC	

These particulars are intended to give a fair and reliable description of the property but no responsibility for any inaccuracy or error can be accepted and do not constitute an offer or contract. We have not tested any services or appliances (including central heating if fitted) referred to in these particulars and the purchasers are advised to satisfy themselves as to the working order and condition. If a property is unoccupied at any time there may be reconnection charges for any switched off/disconnected or drained services or appliances - All measurements are approximate. If you are thinking of selling your home or just curious to discover the value of your property, Hunters would be pleased to provide free, no obligation sales and marketing advice. Even if your home is outside the area covered by our local offices we can arrange a Market Appraisal through our national network of Hunters estate agents.





